

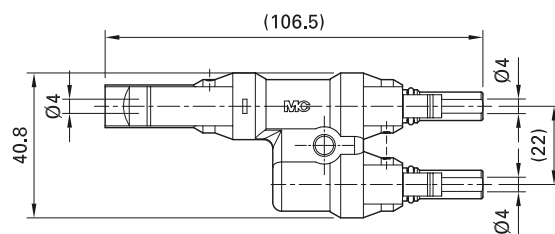

# Branch socket, branch plug MC4

PV-AZB4

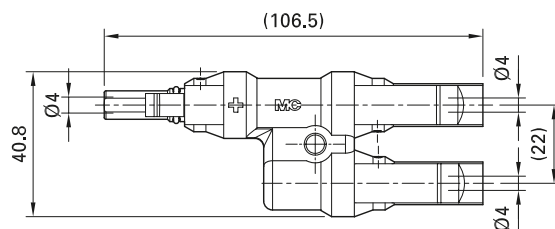

PV-AZS4



| Order No. | Type    | Description   | Approvals  |
|-----------|---------|---------------|--|
| 32.0018   | PV-AZB4 | Branch socket |  |
| 32.0019   | PV-AZS4 | Branch plug   |  |



Sealing caps page 62

Unlocking tool page 69



Assembly Instructions MA250

[www.staubli.com/electrical](http://www.staubli.com/electrical)

- For a safe and simple parallel or serial-parallel connection of PV-modules.
- Pluggable with single-pole Stäubli PV-cable coupler MC4. Unmated connections must be protected by sealing caps.

| Technical data   |                      |
|--|----------------------|
| Connector system                                       | Ø 4 mm               |
| Rated voltage  | 1500 V DC (UL)       |
| Rated current  | 50 A                 |
| Rated impulse voltage                                  | 12 kV                |
| Ambient temperature range                              | -40 °C...+75 °C (UL) |
| Upper limiting temperature                             | 105 °C (Stäubli)     |
| Degree of protection, mated<br>unmated                 | IP67<br>IP2X         |
| Overvoltage category / Pollution degree                | CATIII / 2           |
| Contact resistance of plug connectors                  | ≤ 0.5 mΩ             |
| Safety class   | II                   |
| Contact system   | MULTILAM             |
| Contact material                                       | Copper, tin plated   |
| Insulation material                                    | PC                   |
| Locking system (UL)                                    | Locking type         |
| Flame class  | UL94-V0              |
| UL recognized component,<br>in accordance with UL 6703 | E343181              |

