

## FIXING ACCESSORIES

Clipsal offers a range of fixing accessories for conduit products: metal full saddles (plated and stainless steel)

- metal half saddles
- with and without nails fitted
- full moulded saddles
- spacers
- moulded clips for direct mounting or use with a mounting channel.

### Full Saddles - Metal

A full range of full metal saddles is manufactured in plated finishes and a more limited range in stainless steel.

Plating finish options include black zinc, standard zinc plate, and hot dip galvanised.

### Half Saddles - Metal

A comprehensive range of half saddles is also available to provide sure fixing and quicker installation. 16mm, 20mm and 25mm sizes are available with larger diameter mounting holes.

#### Metal Saddles

Cat. Number	Size	Finish	Gauge	Hole Diameter	Centres	Length	Width	Height
170GM	12.7mm	Zinc Plate	.7mm	5mm	28mm	40mm	13mm	14mm
170M	12.7mm	Black Zinc	.7mm	5mm	28mm	40mm	13mm	14mm
171GM	16mm	Zinc Plate	.7mm	5mm	32mm	45mm	13mm	18mm
171M	16mm	Black Zinc	.7mm	5mm	32mm	45mm	13mm	18mm
172GM	20mm	Zinc Plate	.7mm	5mm	39mm	50mm	16mm	23mm
172M	20mm	Black Zinc	.7mm	5mm	39mm	50mm	16mm	23mm
173GM	25mm	Zinc Plate	.9mm	5mm	48mm	62mm	19mm	28mm
173M	25mm	Black Zinc	.9mm	5mm	48mm	62mm	19mm	28mm
174GM	32mm	Zinc Plate	1.2mm	6mm	63mm	79mm	25mm	35mm
174M	32mm	Black Zinc	1.2mm	6mm	63mm	79mm	25mm	35mm
175GM	40mm	Zinc Plate	1.2mm	6mm	71mm	87mm	25mm	44mm
175M	40mm	Black Zinc	1.2mm	6mm	71mm	87mm	25mm	44mm
176GM	50mm	Zinc Plate	1.2mm	6mm	92mm	108mm	25mm	53mm
176M	50mm	Black Zinc	1.2mm	6mm	92mm	108mm	25mm	53mm
178/63	63mm	Zinc Plate	1.6mm	7mm	107mm	130mm	39mm	66mm
178/80PP	80mm	Zinc Plate	1.6mm	9mm	136mm	166mm	40mm	92mm
178/100PP	100mm	Zinc Plate	1.6mm	9mm	160mm	190mm	40mm	118mm

#### Stainless Steel Saddles

Cat. Number	Size	Gauge	Max. Slot Width	Hole Diameter	Centres	Length	Width	Height
172SS	20mm	.9mm	135mm	5mm	39mm	50mm	20mm	24mm
173SS	25mm	.9mm	135mm	5mm	48mm	62mm	20mm	28mm
174SS	32mm	.9mm	135mm	5mm	63mm	79mm	25mm	35mm
175SS	40mm	1.2mm	135mm	5mm	71mm	87mm	25mm	44mm
176SS	50mm	1.2mm	135mm	5mm	92mm	108mm	25mm	55mm

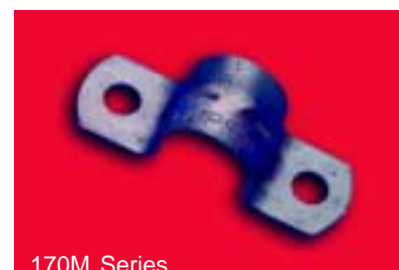
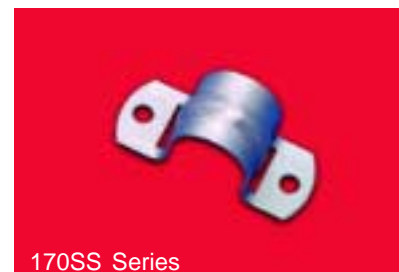
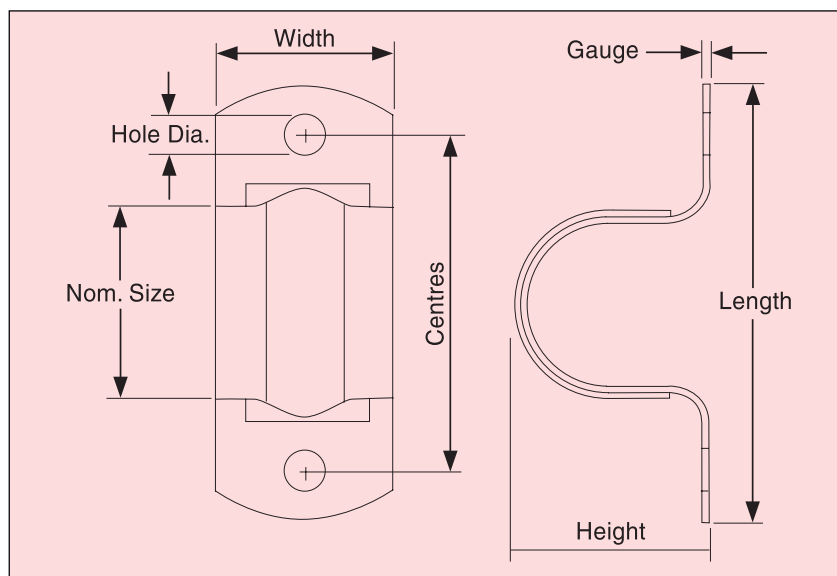

#### Zinc Plated Half Saddles

Cat. Number	Size	Finish	Gauge	Hole Diameter	Length	Width	Height
180/12	12.7mm	Zinc Plate	.7mm	5mm	36mm	16mm	15mm
180/16	16mm	Zinc Plate	1.4mm	5mm	46mm	19mm	18mm
180/20	20mm	Zinc Plate	1.4mm	5mm	50mm	19mm	22mm
180/32	32mm	Zinc Plate	1.2mm	7mm	67mm	24mm	33mm
180/40	40mm	Zinc Plate	1.2mm	7mm	74mm	32mm	41mm
180/50	50mm	Zinc Plate	1.6mm	7mm	85mm	39mm	54mm
180A16	16mm	Zinc Plate	1.4mm	6.5mm	46mm	19mm	18mm
180A20	20mm	Zinc Plate	1.4mm	6.5mm	50mm	19mm	22mm
180A25	25mm	Zinc Plate	1.2mm	6.5mm	60mm	25mm	66mm

#### Zinc Plated Half Saddles with Fixing Nails

Cat. Number	Size	Finish	Gauge	Nail Size	Length	Width	Height
180N16	16mm	Zinc Plate	1.4mm	25 x 2.8mm	46mm	19mm	18mm
180N20	20mm	Zinc Plate	1.4mm	25 x 2.8mm	50mm	19mm	22mm
180N25	25mm	Zinc Plate	1.2mm	25 x 2.8mm	57.3mm	26mm	26mm

#### Half Saddles with Nails

A limited range of Half Saddles is also available with hardened masonry nails.



180 Series



180N Series

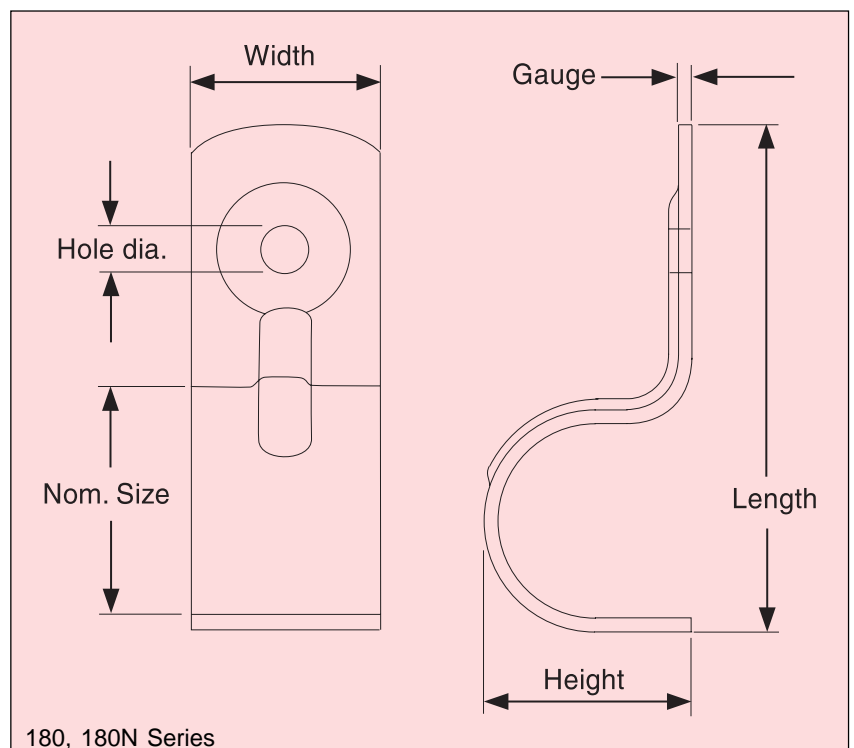

180, 180N Series

## Full Saddles - Moulded

Where neatness and corrosion resistance are imperative, moulded saddles are often the best solution. The 261 Series is tough and UV resistant, and colour matched to the Clipsal conduit product range.

Sizes 16mm through 50mm are Grey (GY) as standard, with Orange (EO) available at extra cost.

The 261/63 is only available in Orange (EO).

### Moulded Full Saddles

Cat. No.	Saddles Diameter	Length (L)	Width (W)	Overall Height	Mounting Centres
261/16	16mm	46mm	15mm	18mm	32mm
261/20	20mm	57mm	16mm	23mm	40mm
261/25	25mm	63mm	20mm	29mm	48mm
261/32	32mm	82mm	22mm	35mm	60mm
261/40	40mm	84mm	24mm	45mm	65mm
261/50	50mm	105mm	27mm	56mm	78mm
*261/63	63mm	120mm	33mm	69mm	91mm

\*Standard colour - Orange.



261 Series

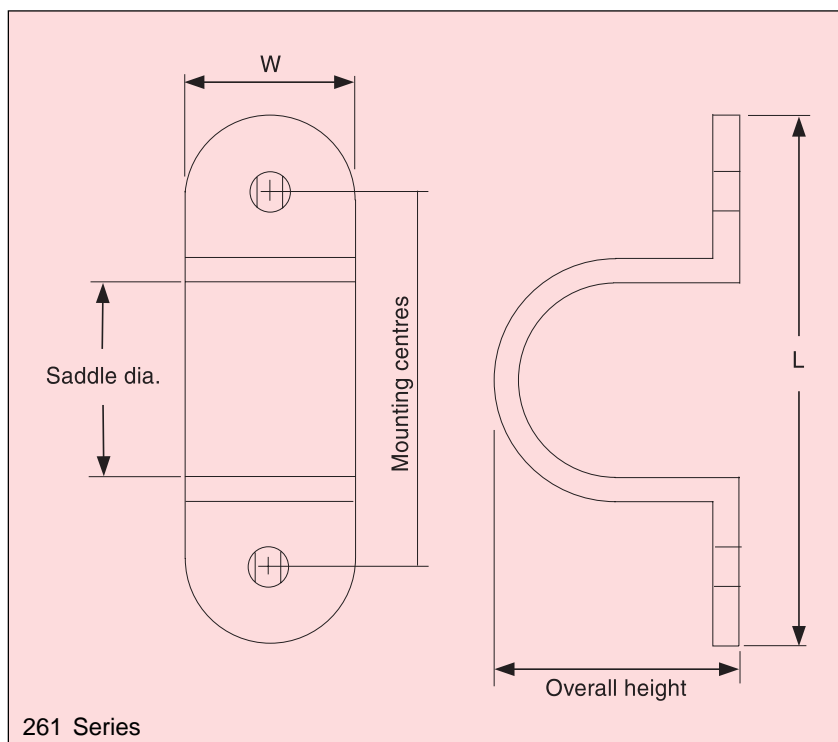

261 Series

## Saddle Spacers

Saddles Spacers set a conduit run off the wall 8mm to allow easier cleaning and repainting and to facilitate entry into equipment. They are available in sizes 16mm through 25mm.

Standard colour is Grey (GY), with Orange (EO) also available at extra cost.

### Saddle Spacers

Catalogue Number	Size	Length (L)	Width (W)	Centres (Crs.)	Standoff (T)	Height (H)
261S16	16mm	55mm	21mm	32mm	8mm	14mm
261S20	20mm	61mm	22mm	40mm	8mm	14mm
261S25	25mm	74mm	26mm	48mm	8mm	14mm

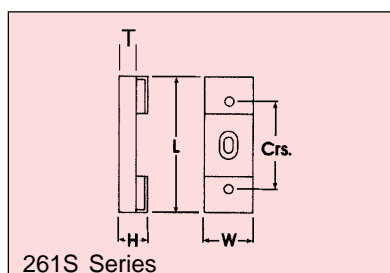

261S Series



261S Series

### Saddle Extension Spacers

Extension Spacers allow the stand off provided by the spacers to be extended a further 18mm. They are only available in 20mm and 25mm sizes.

Standard colour is Grey (GY), with Orange (EO) available at extra cost.

#### Saddle Extension Spacers

Cat. No.	To Suit Cat. No.	Length (L)	Width (W)	Height (H)
<b>261E20</b>	261S20	61mm	22mm	18mm
<b>261E25</b>	261S25	74mm	26mm	18mm

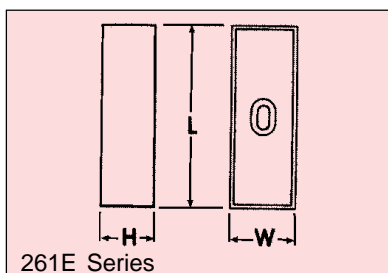

### 280 Series Conduit Clips

280 Series Conduit Clips are a clip in type conduit mount that can be mounted direct onto a wall or other surface, or slid into a 280MC Mounting Channel. They are available in sizes 16mm through to 50mm, and provide a standoff of between 9mm and 13mm.

Standard colour is Grey (GY), with Orange (EO) available at extra cost.

#### 280 Series Conduit Clips

Cat. No.	Conduit Accommodated	Standoff (S)	Length (L)	Height (H)	Width (W)
<b>280/16</b>	16mm	9mm	22mm	23mm	12mm
<b>280/20</b>	20mm	11mm	27mm	29mm	12mm
<b>280/25</b>	25mm	13mm	34mm	36mm	12mm
<b>280/32</b>	32mm	9mm	41mm	38mm	12mm
<b>280/40</b>	40mm	12mm	49mm	46mm	12mm
<b>280/50</b>	50mm	13mm	62mm	54mm	12mm

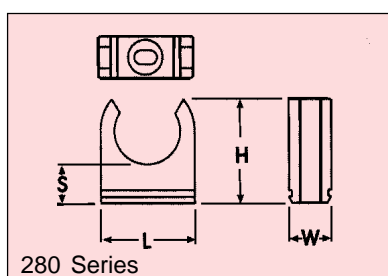

### 280 Series Mounting Channel

The 280 Series Mounting System is a fast and economical way of mounting a series of parallel conduits. Simply fix the mounting channel at the required spacing over the conduit route. The clips slide into the channel, and the conduit clips into place. The channels can be mounted adjacent and interlocked.

Standard colour is Grey (GY), with Orange (EO) available at extra cost.

