



Essential SmartBright G2 LED Downlight DN029B

DN029B G2 LED8/CCT PSR-E D90 CAU

The Philips SmartBright G2 LED downlight provides a professional and flexible solution for a wide variety of applications. Offering three selectable colour temperatures plus integrated dimming capability, the G2 downlight makes it really easy to create the perfect ambience for your unique environment. This affordable and quick to install fitting delivers high energy savings without compromising on light quality.

Product data

General Information		Controls and Dimming	
Lamp colour code	3000/4000/6500	Dimmable	Yes
Light source	No		
replaceable			
Luminaire light beam spread	100°		
Connection	Plug-in connector 2-pole		
Protection class IEC	Safety class II (II)		
Operating and Electrical		Mechanical and Housing	
Input Voltage	220 to 240 V V	Housing material	Metal-Plastic
Input frequency	50 or 60 Hz	Reflector material	Polycarbonate
Power factor (min.)	0.8	Optic material	Polycarbonate
		Fixation material	Stainless steel
		Optical cover/lens finish	Frosted
		Overall length	114 mm
		Overall width	114 mm
		Overall height	56 mm
		Overall diameter	114 mm
		Colour	White

Essential SmartBright G2 LED Downlight DN029B

Dimensions (height x width x depth)	56 x 114 x 114 mm (2.2 x 4.5 x 4.5 in)
Approval and Application	
Ingress protection code	IP40/IP54 front
Mech. impact protection code	IK03 [0.3 J]
Initial Performance (IEC Compliant)	
Initial luminous flux	800 lm
Initial LED luminaire efficacy	106.00 lm/W
Lamp colour temperature	3000 4000 6500 K
Colour Rendering Index	80
Initial chromaticity	(3000K@, 0.4400, 0.40304000K@0.37600.36566500K@0.31300.3370) 6
Initial input power	7.5 W
Power consumption tolerance	+/-10%
Over Time Performance (IEC Compliant)	
Median useful life	30000 h
L70B50	

Application Conditions	
Ambient temperature range	-20 to +40 °C
Product Data	
Full product code	871951425177900
Order product name	DN029B G2 LED8/CCT PSR-E D90 CAU
EAN/UPC – product	8719514251779
Order code	929002531219
Local order code	DN029BLED8CCT90
SAP numerator – quantity per pack	1
Numerator – packs per outer box	12
SAP material	929002531219
Net Weight (Piece)	0.230 kg



Dimensional drawing

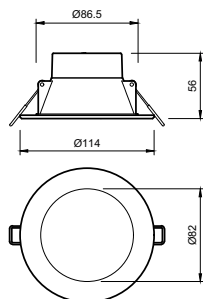

DN029B G2 LED8 3CCT 9W D90 DIM AU

Essential SmartBright G2 LED Downlight DN029B

Photometric data

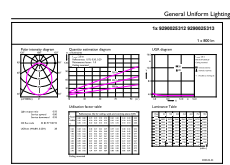

General Information
Page 10

Downlight DN029B G2 LED8 CCT PSR D90

Lifetime

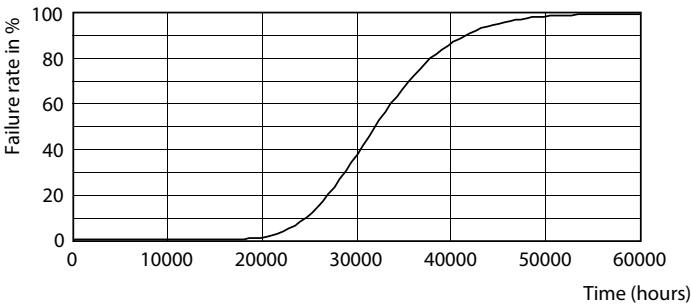
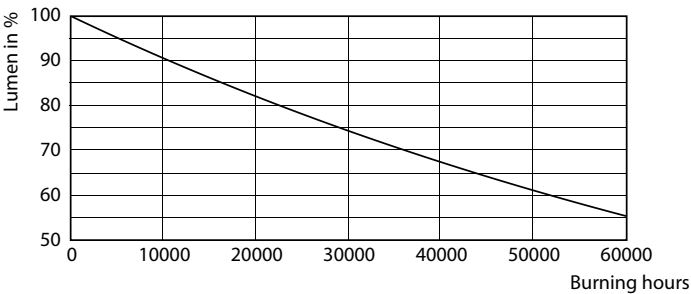

B50L70 30K LMP

B50L70 30K LED

